

Green Living™ Technologies, LLC

Green Living™ Roofs
Green Living™ Walls and Accessories

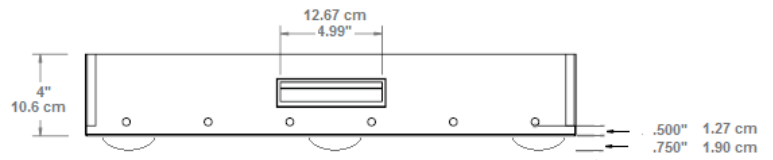
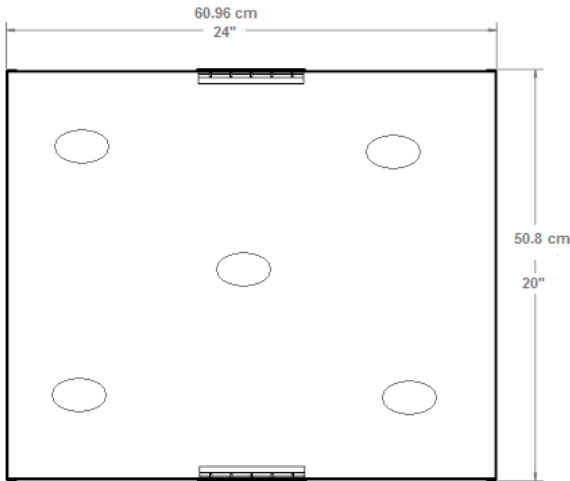

ALSO AVAILABLE IN 6" and 8" DEPTHS
 CAN BE CUSTOMIZED TO ADD ADDITIONAL WATER RETENTION FOR ADDITIONAL STORM WATER RETENTION AND CONTROL

- Constructed of heavy duty (.05") recycled / recyclable aluminum, stainless and zinc. (Please specify)
- .750" embossed feet allow for air flow and drainage under the Green Living Roof Tray
- Complete with water retention mat(s)
- Minimum 3" growing media depth
- Planted in Place or Pre-Vegetated Options available

EMPTY WEIGHT = 3.98 lbs
 WATER RETENTION AS SEEN = 4.35 +/- *gallons (16.5 liters +/-) *Can be increase with additional Water Retention Mat
 SATURATED WEIGHT = 52.5 lbs (15 lbs per sf)

**GREEN LIVING™ ROOF TRAY
 SINGLE PLY MEMBRANES**

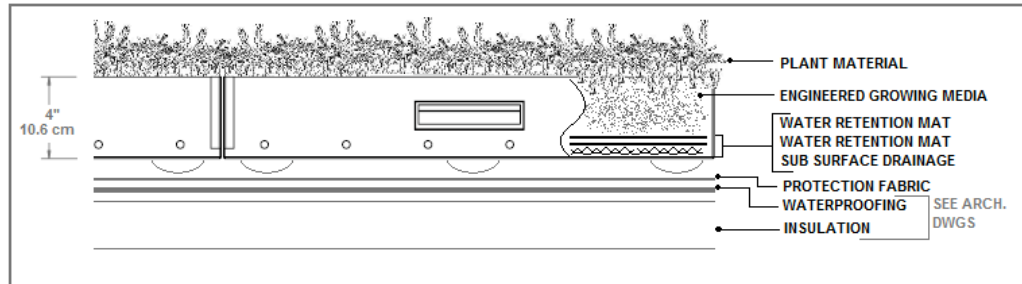

**GREEN LIVING™ ROOF TRAY
 PROTECTED MEMBRANE APPLICATION**

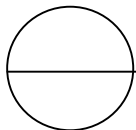
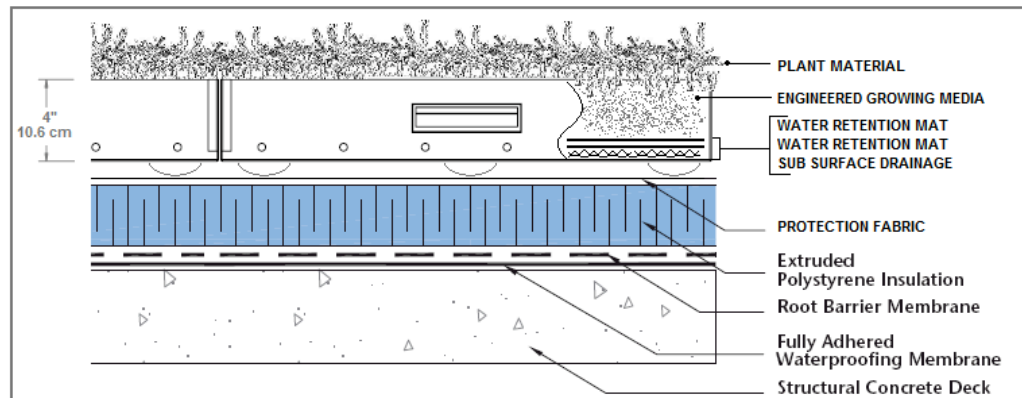

Green Living™ Roof Tray Details and Installation Details

Green Living™ Technologies, LLC
 191 Imperial Circle
 Rochester New York 14617
 800-631-8001 www.agreenroof.com



DO NOT SCALE